



We are touched by the many messages of support we have received from our friends, partners, and customers. Many of you ask what you can do about the situation in Ukraine, or what organizations you should donate to help the most. We have decided to create a donation campaign for [World Central Kitchen](#). They have the experience of mobilizing and organizing to feed people in crisis situations. The WCK policy of staying to work with local chefs to build capacity also makes sense to us.

If you would like to donate some cash, please visit the [campaign site](#).

Thank you for being so supportive!

Webinar: Energy Efficiency in Retrofitting Projects

Hosted by
LEDs
MAGAZINE

The webinar will be held on March 31, 2022
11:00 AM EDT / 10:00 AM CDT / 8:00 AM PDT /
3:00 PM GMT



SILVAIR

Jim Sekinger
Head of Sales,
North America
at Silvaair



Hosted by
LinmoreLED

Paul Chamberlain
President and CEO
at Linmore LED Labs

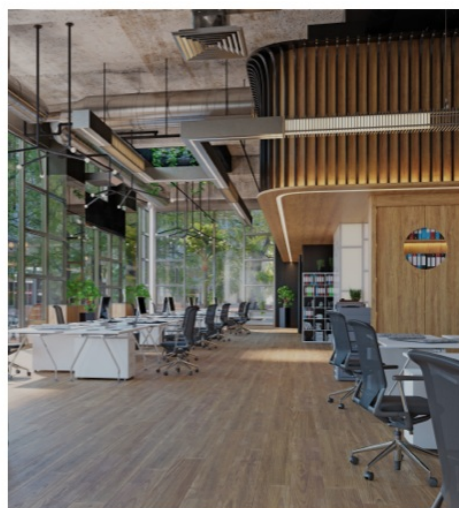

Webinar: Energy efficiency in retrofitting projects!

Together with **LEDs Magazine** we are happy to invite you to our upcoming webinar: *Energy Efficiency in Retrofitting Projects* that will be held on **Thursday, March 31, 2022 at 11:00 AM EDT / 10:00 AM CDT / 8:00 AM PDT / 3:00 PM GMT**

Our guest will be **Paul Chamberlain** from [Linmore LED Labs](#) and together we will discuss how high-performance lighting delivers initial tremendous energy efficiency, how an energy dashboard can monitor ongoing system performance, and how data can be turned into valuable insights leading to additional savings.

[REGISTER HERE](#)



photo credit: McWong & Auto Conduct

McWong and LA Lighting Collaborate to Light Up Innovative Car Culture Event Space

[McWong International](#) partnered with LA Lighting to create an LED lighting system controlled by a **Bluetooth mesh wireless network** to bring a unique, one-acre car exhibition to life. The event and storage complex in downtown LA is owned and operated by Auto Conduct - a car culture community experience company.

The goal was to create a responsive lighting system capable of showcasing a range of vehicles during different times of day and night. The project team created a flexible, white-tunable LED lighting system with embedded Bluetooth mesh controls in each fixture.

[SEE THE RESULTS](#)

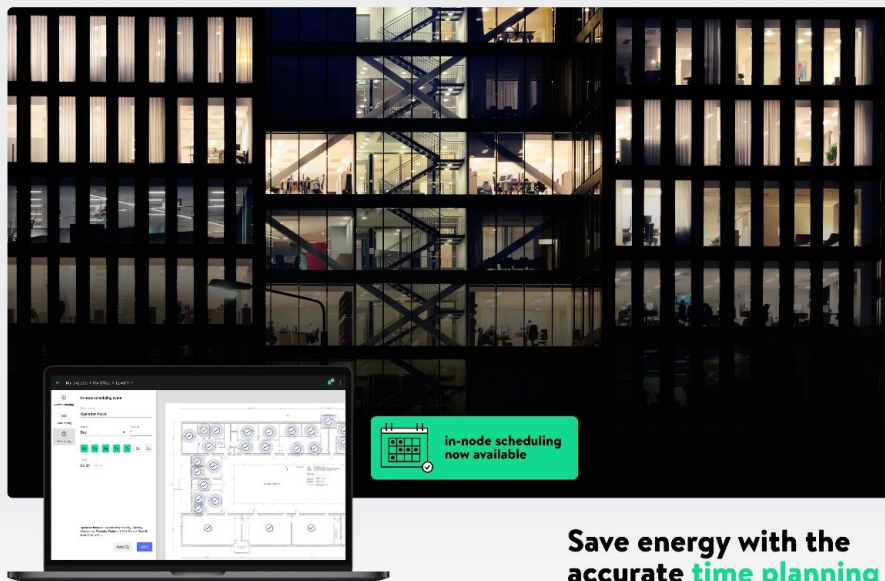

Save energy with the accurate **time planning**

How Bluetooth mesh simplifies wireless lighting control

The latest addition to our lighting control solution is the **in-node scheduling** feature, the most cost-effective way to put your luminaires on schedule without additional hardware requirements. You might have already seen the dedicated newsletter with valuable information about this innovative capability. If not, please visit our [website](#) and [social media](#)

channels to learn more about in-node scheduling.

You can also have a look at our article for the **LEDs Magazine** where we compare in-node and gateway-enabled scheduling implementations.

[READ THE ARTICLE](#)



Coming up next: emergency lighting testing

The next big feature on our roadmap is a standalone emergency lighting testing solution. Our goal is to deliver a cost-efficient ELT capability that will reduce maintenance costs and facilitate the testing process. The feature will be launched in a matter of weeks and the first devices will show up on the market soon after that. Let us know at business@silvair.com if you consider launching Bluetooth mesh ELT devices or if there are ELT projects in your pipeline - we will provide you with more details and additional materials.



Twitter



LinkedIn

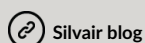

Silvair blog

[unsubscribe from this list](#)

[update subscription preferences](#)

[View this email in your browser](#)

SILVAIR

