

Greentom

Chassis

Greentom Chassis overview / przegląd elementów

A handle bar

rączka

B push button

przycisk

C brake

hamulec

D basket

koszyk

E footrest

podnózek

F push / turn button

przycisk / pokrętło

G safety bar

barierka bezpieczeństwa

YOU instruction video:
Tube www.greentom.com/service

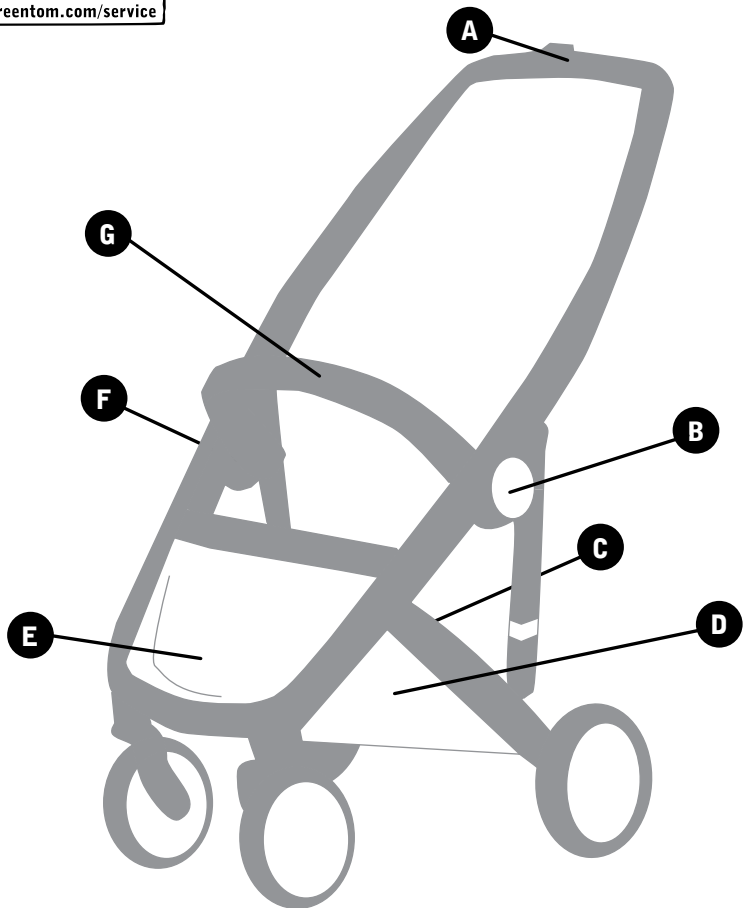

unfolding / rozkładanie

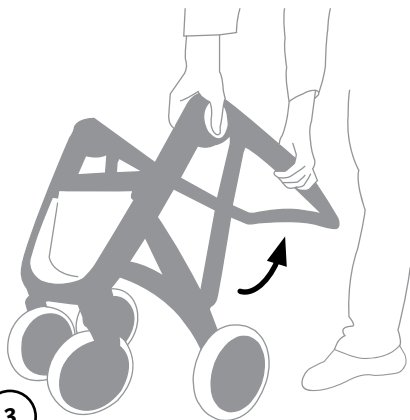
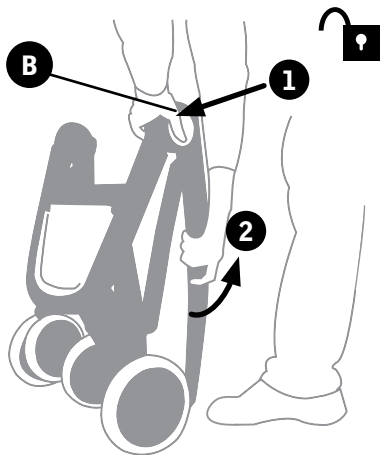
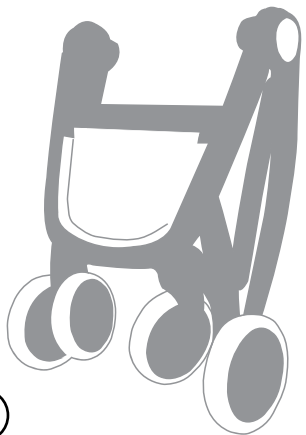

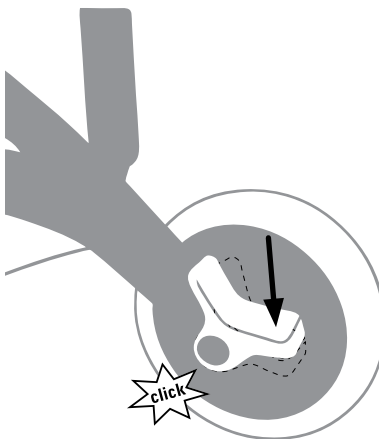
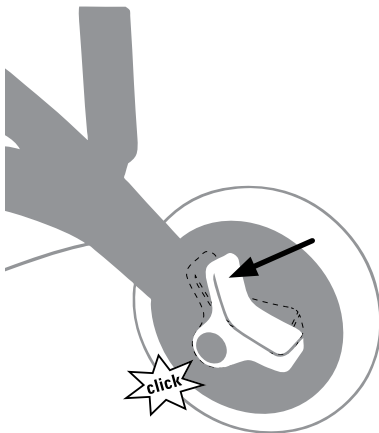

folding / składanie

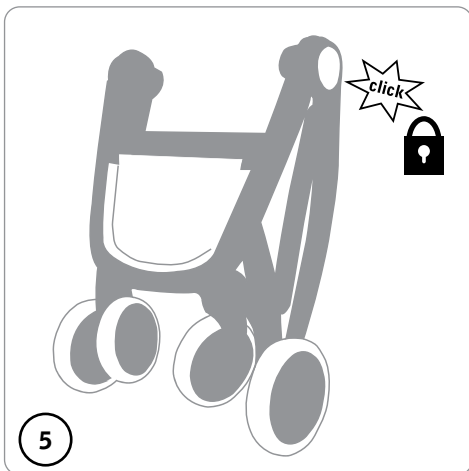
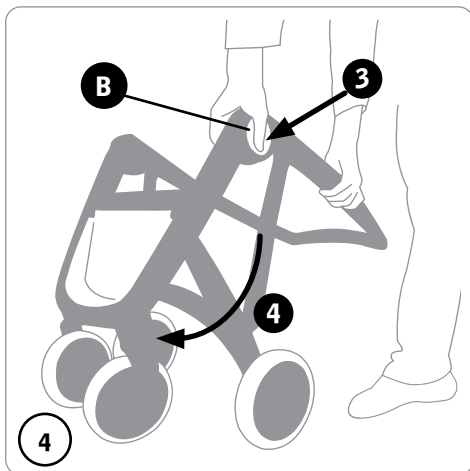
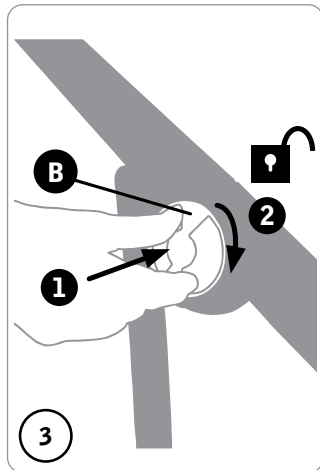
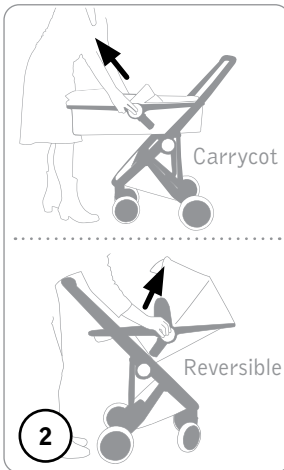
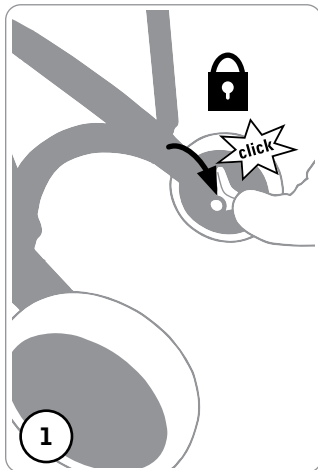



Remove Reversible seat or Carrycot before folding the chassis!

The basket is suitable for loads up to 2 kg / 4.5 lb.



Zdejmij siedzisko Reversible lub gondolę Carrycot zanim złożysz ramę/podwozie!

Maksymalne obciążenie koszyka wynosi 2 kg.

1-7 assembly basket / montaż koszyka

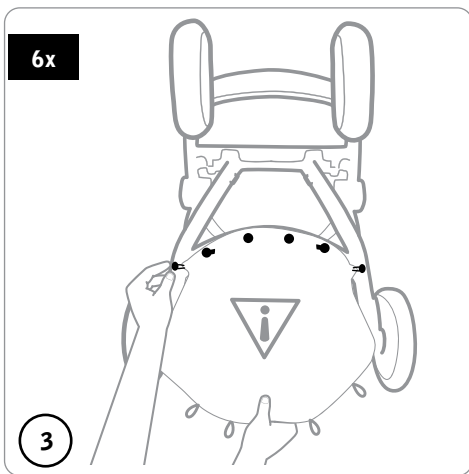
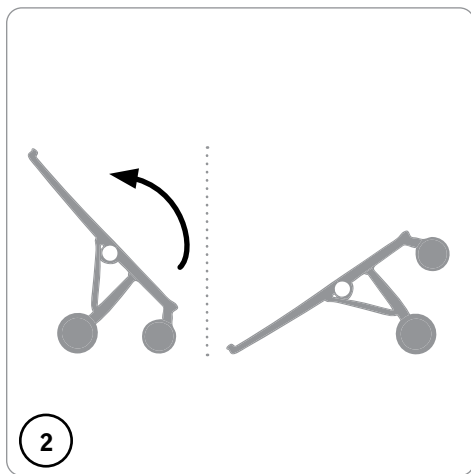
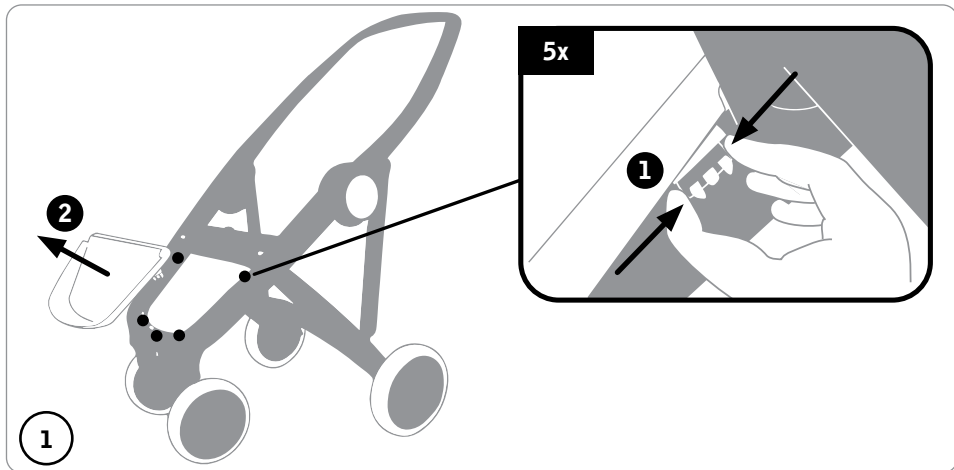

assembly basket / montaż koszyka 1 - 7

