

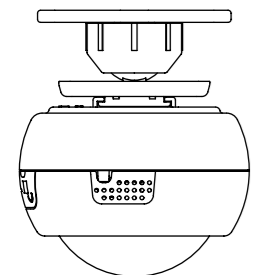

MULTISENSOR GEN5



View the expanded manual: <http://aeotec.com/support>



1 Aeotec by Aeon Labs MultiSensor.

Motion sensor. Humidity sensor. Thermometer. Light sensor.

The corner of your room just got smart.

Aeotec by Aeon Labs' MultiSensor looks like a motion sensor and it acts like one too. But it's also so much more. Installing this 1 piece of Z-Wave® technology is the same as installing 4 pieces of Z-Wave technology. Your home control network will immediately understand motion, temperature, humidity and light readings wherever MultiSensor installed. Those intelligent readings will equate to intelligence automation. And intelligent automation will give you the perfect, smart home.

2 Familiarize yourself with your MultiSensor.

Your MultiSensor comes packaged with a number of accessories that will help with its installation and operation.

Package Contents:

- 1) MultiSensor
- 2) Back-Mount Plate
- 3) Back-Mount Arm
- 4) USB Cable
- 5) Screws (x2)

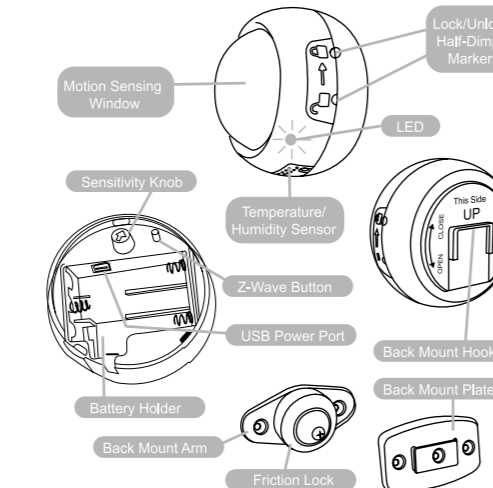
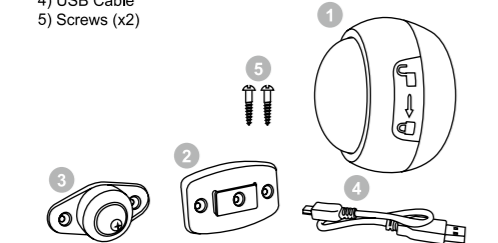

3 Quick start.

• Setup your power.

Your MultiSensor can be powered by battery or by USB with an appropriate adaptor. For the purposes of installation and setup, and even if you intend to power your sensor with batteries, we recommend utilising the provided USB cable for setup. For this you'll need an adaptor to plug your USB cable into, this can include any USB port on a computer and most mobile phone chargers. These first steps can be performed in any location with your home, and not necessarily in your MultiSensor's final installation location.

For a USB powered installation:

1. Remove the rear part of your sensor by twisting the battery cover in a counter-clockwise motion and separating the two parts of your sensor.

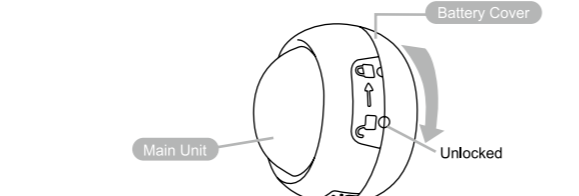

2. Insert the appropriate end of the provided USB cable into your sensor's USB port. Your MultiSensor is now powered on.

For a battery powered installation:

1. Remove the rear part of your sensor as shown in the previous step 1.
2. Insert 4 AAA batteries oriented according to the picture below. Your MultiSensor is now powered on.

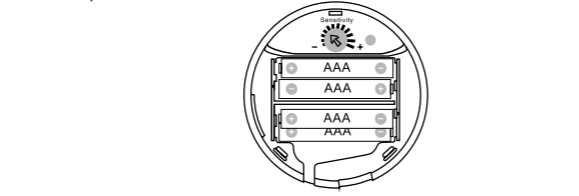

• Add your MultiSensor to your Z-Wave network.

It's now time to sync your MultiSensor with a Z-Wave network. The following instructions explain how to do this using a Z-Stick or a Minimote from Aeotec. If you're using an alternative controller for your Z-Wave network, please refer to its user manual for network inclusion instructions.

If you're using a Z-Stick:

1. Take your Minimote to your MultiSensor.
2. Press the Include button on your Minimote.
3. Press the Z-Wave Button on your MultiSensor.
4. You can test if your MultiSensor has been successfully synced with your Z-Wave network by pressing its Z-Wave Button. If you press the button and your sensor's LED illuminates for a few seconds, then syncing has been successful. If the LED blinks when the button is pressed, the syncing has been unsuccessful and you should repeat the above steps.
5. Press any button on your Minimote to return it to standard operating mode.

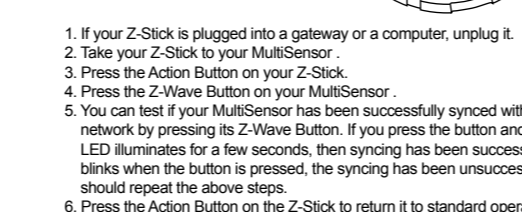

If you're using a Minimote:

1. If your Z-Stick is plugged into a gateway or a computer, unplug it.
2. Take your Z-Stick to your MultiSensor.
3. Press the Action Button on your Z-Stick.
4. Press the Z-Wave Button on your MultiSensor.
5. You can test if your MultiSensor has been successfully synced with your Z-Wave network by pressing its Z-Wave Button. If you press the button and your sensor's LED illuminates for a few seconds, then syncing has been successful. If the LED blinks when the button is pressed, the syncing has been unsuccessful and you should repeat the above steps.
6. Press the Action Button on the Z-Stick to return it to standard operating mode. Return it to your gateway or computer.

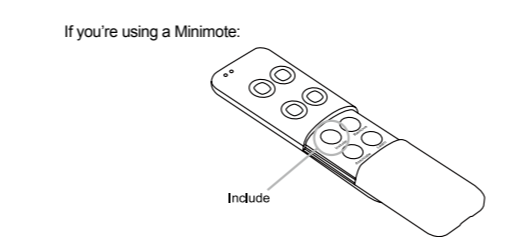

For ceiling mounting using the Back-Mount Plate:

1. Take your MultiSensor to your MultiSensor.
2. Press the Include button on your Minimote.
3. Press the Z-Wave Button on your MultiSensor.
4. You can test if your MultiSensor has been successfully synced with your Z-Wave network by pressing its Z-Wave Button. If you press the button and your sensor's LED illuminates for a few seconds, then syncing has been successful. If the LED blinks when the button is pressed, the syncing has been unsuccessful and you should repeat the above steps.
5. Press any button on your Minimote to return it to standard operating mode.

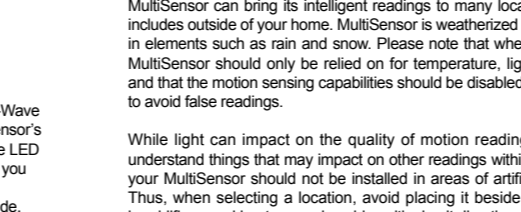

For wall mounting using the Back-Mount Arm:

1. Take your MultiSensor to your MultiSensor.
2. Press the Include button on your Minimote.
3. Press the Z-Wave Button on your MultiSensor.
4. You can test if your MultiSensor has been successfully synced with your Z-Wave network by pressing its Z-Wave Button. If you press the button and your sensor's LED illuminates for a few seconds, then syncing has been successful. If the LED blinks when the button is pressed, the syncing has been unsuccessful and you should repeat the above steps.
5. Press any button on your Minimote to return it to standard operating mode.

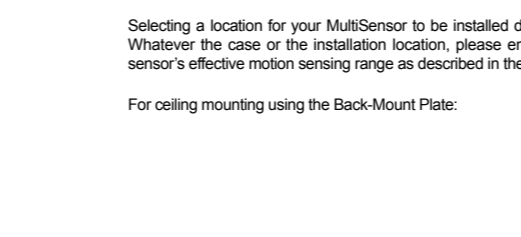

Further, for optimal performance your MultiSensor should NOT be mounted directly on or near metal framing or other large metallic objects. Large metal objects may weaken the Z-Wave wireless signal.

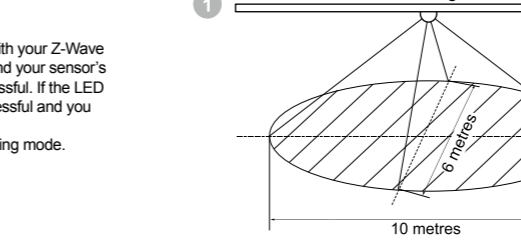

• Selecting a location for your MultiSensor.

MultiSensor can bring its intelligent readings to many locations of your home. That includes outside of your home. MultiSensor is weatherized and can operate outdoors in elements such as rain and snow. Please note that when installed outdoors, your MultiSensor should only be relied on for temperature, light and humidity readings and that the motion sensing capabilities should be disabled on your gateway in order to avoid false readings.

While light can impact on the quality of motion readings, it's also important to understand things that may impact on other readings within your home. Specifically, your MultiSensor should not be installed in areas of artificial temperature change. Thus, when selecting a location, avoid placing it beside or near air conditioners, humidifiers, and heaters, and avoid positioning it directly opposite a window or direct sunlight.

Selecting a location for your MultiSensor to be installed depends on the use case. Whatever the case or the installation location, please ensure that it fits with your sensor's effective motion sensing range as described in these diagrams.

For ceiling mounting using the Back-Mount Plate:

1. Reattach the two parts of your MultiSensor to each other. To do this, align the lock/unlock half-dimple markers that are under the unlock symbol and then twist in a clockwise motion.

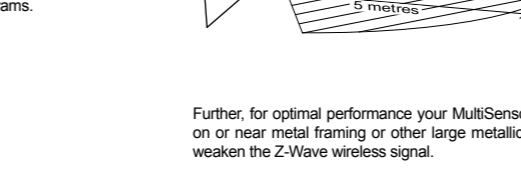

For wall mounting using the Back-Mount Arm:

1. Take your MultiSensor to your MultiSensor.
2. Press the Include button on your Minimote.
3. Press the Z-Wave Button on your MultiSensor.
4. You can test if your MultiSensor has been successfully synced with your Z-Wave network by pressing its Z-Wave Button. If you press the button and your sensor's LED illuminates for a few seconds, then syncing has been successful. If the LED blinks when the button is pressed, the syncing has been unsuccessful and you should repeat the above steps.
5. Press any button on your Minimote to return it to standard operating mode.

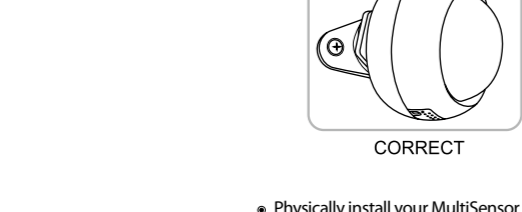

• Physically install your MultiSensor.

With your MultiSensor now part of your Z-Wave network, it's time to finish its physical installation.

There are 2 ways that your MultiSensor can be mounted on on a wall or ceiling. Using the Back-Mount Plate, you can mount it flat against a wall or ceiling. Using the Back-Mount Arm you can mount it on a surface or in a corner and angle it as desired.

To physically install your MultiSensor,

1. Reattach the two parts of your MultiSensor to each other. To do this, align the lock/unlock half-dimple markers that are under the unlock symbol and then twist in a clockwise motion.

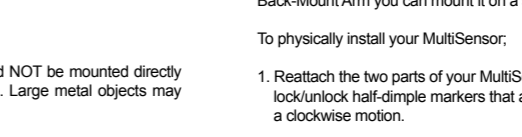

If selecting an outdoor location, it's important to position your MultiSensor in a sheltered location. It is best if your MultiSensor is not directly exposed to rain and integral that the humidity venting on your MultiSensor near is. As such, during installation you should orient your MultiSensor according to the following diagram so that the sensor perforations on the side of your sensor are facing downwards.

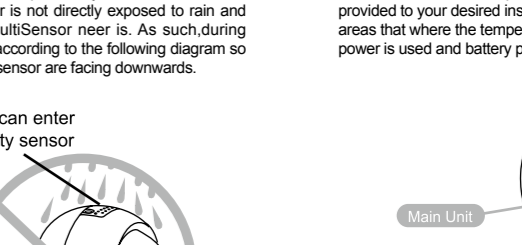

• Attach your desired mounting accessory. This can be the Back-Mount Plate or the Back-Mount Arm.

3. Attach your desired mounting accessory. This can be the Back-Mount Plate or the Back-Mount Arm.

4. If using the Back-Mount Plate, utilize the provided 3mm screws to affix it to a surface.

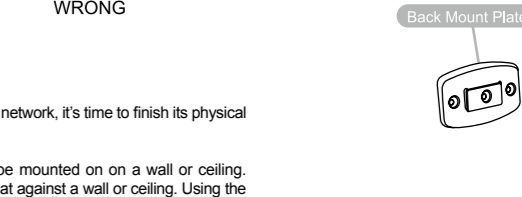

5. If using the Back-Mount Arm, utilize one 3x10mm screw to attach the Back-Mount Plate to the Back-Mount Arm. Then affix the Back-Mount Arm to a surface utilizing the provided 3x20mm screws.

6. The Back-Mount Arm may be locked at various angles by turning the Friction Lock clockwise and counter-clockwise to respectively tighten or loosen the angle of the arm.

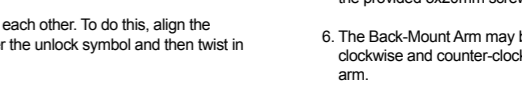

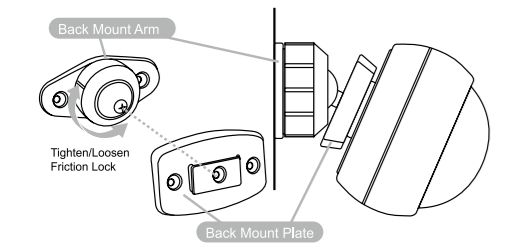

#### 4 Advanced functions.

##### ● Changing batteries.

Your MultiSensor has built in battery level detection. It will automatically report its battery level to the associated control point throughout its life until the battery is fully drained and needs replacing. The battery status will often be displayed in the user interface of the control point.

When used properly in an optimised Z-Wave network, your MultiSensor can be powered by batteries for 12 months before battery replacement is necessary.

**Recommendation:** For networks which do not offer a method to display the battery level of your MultiSensor, it is recommended that the sensor be tested occasionally to ensure that the batteries still hold enough charge to operate. Batteries naturally lose their charge over time.

##### ● Removing your MultiSensor from a Z-Wave network.

Your MultiSensor can be removed from your Z-Wave network at any time. You'll need to use your Z-Wave network's main controller to do this and the following instructions tell you how to do this using Aeotec by Aeon Labs' Z-Stick and Minimote controllers. If you are using other products as your main Z-Wave controller, please refer to the part of their respective manuals that tells you how remove devices from your network.

##### If you're using a Z-Stick:

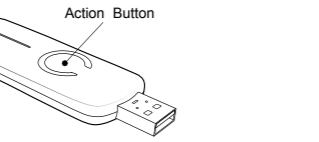

1. If your Z-Stick is plugged into a gateway or a computer, unplug it.
2. Take your Z-Stick to your MultiSensor .
3. Press and hold the Action Button on your Z-Stick for 3 seconds and then release.
4. Press the Z-Wave Button on your MultiSensor .
5. If your MultiSensor has been successfully removed from your network, its LED will blink when you press the Z-wave Button. If the removal was unsuccessful, the LED will stay solid for a few seconds when you press the Z-wave Button.
6. Press the Action Button on the Z-Stick to take it out of removal mode.

##### If you're using a Minimote:

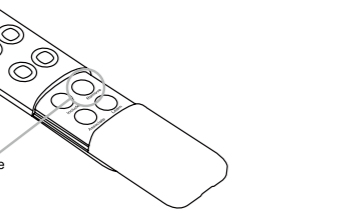

1. Take your Minimote to your MultiSensor.
2. Press the Remove Button on your Minimote.
3. Press the Z-wave Button on your MultiSensor .
4. If your MultiSensor has been successfully removed from your network, its LED will blink when you press the Z-wave Button. If the removal was unsuccessful, the LED will stay solid for a few seconds when you press the Z-wave Button.
5. Press any button on your Minimote to take it out of removal mode.

##### ● Monitoring motion.

The MultiSensor can send Basic Set Command to association group 1, which is setup via the Association Command Class, when the Motion Sensor detects movement to control the associated devices to "OPEN" state. After 4 minutes by default, if the Motion Sensor is not triggered again, the MultiSensor will send Basic Set Command to these devices to set them to their "CLOSE" state. However, if the Motion Sensor is triggered again in 4 minutes, the MultiSensor will reset the timing and start timing again.

The 4 minutes delay time can be changed through the usage of Z-Wave command built into Z-Wave certified control points. (The specific Z-Wave command supporting this function is Configuration Command Class) Please consult the operation manual for these control points for specific instructions on setting the MultiSensor.

##### ● Adjusting the sensitivity of your MultiSensor.

Turn the Sensitivity Knob in a clockwise direction to increase sensitivity and counter-clockwise to decrease sensitivity.

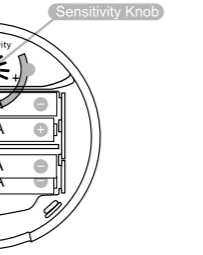

##### ● Monitoring temperature, humidity and luminance.

Your MultiSensor can report temperature, humidity, and luminance across a Z-Wave network when requested. If this function is supported by a controller, generally a

gateway, the data will be displayed within its interface. The specific Z-Wave commands for the support of monitoring is the Multilevel Sensor Command Class and Multi Channel Command Class. Automatic reports are sent to association group 1, which is setup via the Association Command Class. Please consult the controller's operation manual for specific instructions on setting your MultiSensor.

##### Setting automatic report flags.

Parameter 101-103 [4 byte decimal] can be configured through your gateway in case the default settings of your MultiSensor are not what you desire.

Decimal	lag
128	Light Sensor
64	Humidity Sensor
32	Temperature Sensor
1	Battery Sensor

The table above shows a decimal representation of all flags that can be set on parameter 101-103 to report specific data.

##### Example use of the report table.

For example, if you want to report only the temperature and light sensor you would add 32 + 64 and set the sum (96) to parameter 101, 102, or 103.

As another example, if you want to report only the light sensor and battery, you would add 1 + 128, then set the sum (129) to parameter 101, 102, or 103.

And if you want to report all of the sensors, you would add the whole table together and set the sum (225) to parameter 101, 102, or 103.

##### Setting an automatic report interval.

Parameter 111-113 [4 byte decimal] can be configured through your gateway in case the default settings of your MultiSensor are not what you desire.

Parameter 111 will set the interval for Group 1 (parameter 101), parameter 112 will set the interval for Group 2 (parameter 102), and parameter 113 will set the interval for Group 3 (parameter 103).

As an example, you have set parameter 101 to 225 which will report all of the sensors, and you want to report it every 1800 seconds. Set parameter 111 to 1800 to accomplish this.

##### ● Waking up your MultiSensor.

If your MultiSensor is battery powered, you will need to ensure that it is active when configuring it. To do this, press and hold its Z-Wave Button for 3 seconds and then release it. Your MultiSensor's LED should now be solid to indicate that it is active.

When you are done configuring or communicating with your MultiSensor, you can put it back into sleep mode to conserve battery power. To do this, press and hold its Z-Wave button for 3 seconds and then release it. Your MultiSensor's LED should now be off to indicate that it is asleep.

##### ● Resetting your MultiSensor.

At some stage or your primary controller is missing or inoperable, you may also wish to reset all of your MultiSensor's settings to their factory defaults. To do this, press and hold the Z-Wave Button for 20 seconds and then release it. Your MultiSensor will now be reset to its original settings, and the LED will stay solid for 2 seconds and then turn off as a confirmation.

##### 5 Technical specifications.

Power Supply: USB DC 5V or battery power(4×AAA batteries).  
 Operating Temperature: -10°C to 60°C.  
 Measured Temperature Range: -10°C to 50°C. Accuracy: ±1°C.  
 Humidity Range: 20% to 80%. Accuracy: ±5% (at 25°C).  
 Lighting: 0 to 1000 LUX.  
 Motion Sensitivity: 3 to 5 meters.  
 Water Proofing: IP42.  
 Wireless Range: Up to 500 feet/150 metres outdoors.

##### 6 Warranty.

Aeon Labs warrants to the original purchaser of Products that for the Warranty Period (as defined below), the Products will be free from material defects in materials and workmanship. The foregoing warranty is subject to the proper installation, operation

and maintenance of the Products in accordance with installation instructions and the operating manual supplied to Customer. Warranty claims must be made by Customer in writing within thirty (30) days of the manifestation of a problem. Aeon Labs' sole obligation under the foregoing warranty is, at Aeon Labs' option, to repair, replace or correct any such defect that was present at the time of delivery, or to remove the Products and to refund the purchase price to Customer.

The "Warranty Period" begins on the date the Products is delivered and continues for 12 months.

Any repairs under this warranty must be conducted by an authorized Aeon Labs service representative and under Aeon Labs' RMA policy. Any repairs conducted by unauthorized persons shall void this warranty.

Excluded from the warranty are problems due to accidents, acts of God, civil or military authority, civil disturbance, war, strikes, fires, other catastrophes, misuse, misapplication, storage damage, negligence, electrical power problems, or modification to the Products or its components.

Aeon Labs does not authorize any person or party to assume or create for it any other obligation or liability in connection with the Products except as set forth herein.

Aeon Labs will pass on to Customer all manufacturers' Material warranties to the extent that they are transferable, but will not independently warrant any Material.

Customer must prepay shipping and transportation charges for returned Products, and insure the shipment or accept the risk of loss or damage during such shipment and transportation. Aeon Labs will ship the repaired or replacement products to Customer freight prepaid.

Customer shall indemnify, defend, and hold Aeon Labs and Aeon Labs' affiliates, shareholders, directors, officers, employees, contractors, agents and other representatives harmless from all demands, claims, actions, causes of action, proceedings, suits, assessments, losses, damages, liabilities, settlements, judgments, fines, penalties, interest, costs and expenses (including fees and disbursements of counsel) of every kind (i) based upon personal injury or death or injury to property to the extent any of the foregoing is proximately caused either by a defective product (including strict liability in tort) or by the negligent or willful acts or omissions of Customer or its officers, employees, subcontractors or agents, and/or (ii) arising from or relating to any actual or alleged infringement or misappropriation of any patent, trademark, mask work, copyright, trade secret or any actual or alleged violation of any other intellectual property rights arising from or in connection with the products, except to the extent that such infringement exists as a result of Aeon Labs' manufacturing processes.

IN NO EVENT SHALL AEON LABS BE LIABLE FOR ANY INDIRECT, INCIDENTAL, PUNITIVE, SPECIAL OR CONSEQUENTIAL DAMAGES, OR DAMAGES FOR LOSS OF PROFITS, REVENUE, OR USE INCURRED BY CUSTOMER OR ANY THIRD PARTY, WHETHER IN AN ACTION IN CONTRACT, OR TORT, OR OTHERWISE EVEN IF ADVISED OF THE POSSIBILITY OF SUCH DAMAGES. AEON LABS' LIABILITY AND CUSTOMER'S EXCLUSIVE REMEDY FOR ANY CAUSE OF ACTION ARISING IN CONNECTION WITH THIS AGREEMENT OR THE SALE OR USE OF THE PRODUCTS, WHETHER BASED ON NEGLIGENCE, STRICT LIABILITY, BREACH OF WARRANTY, BREACH OF AGREEMENT, OR EQUITABLE PRINCIPLES, IS EXPRESSLY LIMITED TO, AT AEON LABS' OPTION, REPLACEMENT OF, OR REPAYMENT OF THE PURCHASE PRICE FOR THAT PORTION OF PRODUCTS WITH RESPECT TO WHICH DAMAGES ARE CLAIMED. ALL CLAIMS OF ANY KIND ARISING IN CONNECTION WITH THIS AGREEMENT OR THE SALE OR USE OF PRODUCTS SHALL BE DEEMED WAIVED UNLESS MADE IN WRITING WITHIN THIRTY (30) DAYS FROM AEON LABS'S DELIVERY, OR THE DATE FIXED FOR DELIVERY IN THE EVENT OF NONDELIVERY.

THE INDEMNITY AND WARRANTY IN ABOVE ARE EXCLUSIVE AND IN LIEU OF ALL OTHER INDEMNITIES OR WARRANTIES, WHETHER EXPRESS OR IMPLIED, INCLUDING THE IMPLIED WARRANTIES OF MERCHANTABILITY AND FITNESS FOR A PARTICULAR PURPOSE.

##### FCC NOTICE (for USA)

THE MANUFACTURER IS NOT RESPONSIBLE FOR ANY RADIO OR TV INTERFERENCE CAUSED BY UNAUTHORIZED MODIFICATIONS TO THIS EQUIPMENT.SUCH MODIFICATIONS COULD VOID THE USER'S AUTHORITY TO OPERATE THE EQUIPMENT.

STORE INDOORS WHEN NOT IN USE. SUITABLE FOR DRY LOCATIONS. DO NOT IMMERSE IN WATER. NOT FOR USE WHERE DIRECTLY EXPOSED TO WATER.

This device complies with Part 15 of the FCC Rules. Operation is subject to the following two conditions:

- 1 This device may not cause harmful interference, and
- 2 This device must accept any interference received, including interference that may cause undesired operation. This equipment has been tested and found to comply with the limits for a Class B digital device, pursuant to part 15 of the FCC Rules. These limits are designed to provide reasonable protection against harmful interference in a residential installation. This equipment generates, uses and can radiate radio frequency energy and, if not installed and used in accordance with the instructions, may cause harmful interference to radio communications. However, there is no guarantee that interference will not occur in a particular installation. If this equipment does cause harmful interference to radio or television reception, which can be determined by turning the equipment off and on, the user is encouraged to try to correct the interference by one or more of the following measures:

- Reorient or relocate the receiving antenna.
- Increase the separation between the equipment and receiver.
- Connect the equipment into an outlet on a circuit different from that to which the receiver is connected.
- Consul the dealer or an experienced radio/TV technician for help.

##### Warning

Do not dispose of electrical appliances as unsorted municipal waste, use separate collection facilities. Contact your local government for information regarding the collection systems available.

##### Certifications (regional):



Z-Wave and Z-Wave Plus are registered trademarks of Sigma Designs and its subsidiaries in the United States and other countries

