

**TERRACE RESIDENCE**  
**WOHNUNG 20**  
**TREPPENHAUS FRONT**  
**5. OG LINKS | BARRIEREFREI**  
**4 ZIMMER | 178,92 m<sup>2</sup>**

Wohnküche	kitchen living room	64,45 m <sup>2</sup>
Zimmer 1	bedroom 1	13,89 m <sup>2</sup>
Zimmer 2	bedroom 2	11,18 m <sup>2</sup>
Zimmer 3	bedroom 3	36,39 m <sup>2</sup>
Bad 1	bathroom 1	5,99 m <sup>2</sup>
Bad 2	bathroom 2	6,52 m <sup>2</sup>
WC	WC	3,37 m <sup>2</sup>
Flur	hallway	23,07 m <sup>2</sup>
HWR	laundry   storage	3,06 m <sup>2</sup>
AR	storage	6,12 m <sup>2</sup>
Terrasse*	terrace*	19,46 m <sup>2</sup>
<b>Gesamtwohnfläche</b>	<b>Total Area</b>	<b>178,92 m<sup>2</sup></b>

\*Die Balkone und Loggien sind zu 50 % und alle Terrassen sowie Privatgärten sind zu 25 % in die Wohnfläche eingerechnet.

\*The balconies and loggias are factored into the floor area at a ratio of 50% and the terraces and privat gardens at a ratio of 25 %.

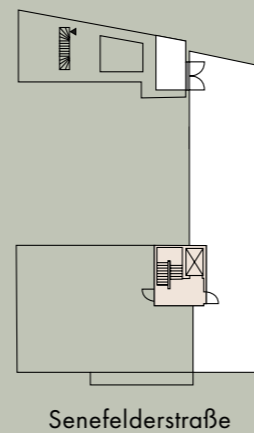

Front Staircase

APT. 20

178,92 m<sup>2</sup>

3-bedroom Apartment | barrier free

Senefelderstraße 21 | Terrace Residence | 5th floor left

