

Live Controller

LIVESIGNAGE



Live Controller

Your screen, your control

Live Controller turns your display into an **interactive interface to manage** content, devices and Livesignage apps, quickly and easily.

Think of it like having a **smart menu right on screen**, just like Netflix: with a single tap, you can switch content, launch apps, or control hardware: no computer needed.



One menu for everything

All your content and settings, accessible in one place.



Instant control

Switch playlists, launch media or turn off your displays all in one click.



Simple and fast

No training needed. Ready to use in minutes.



Lezioni e presentazioni - secondo anno

Scenario
Crimini 2

Scenario
Fisica 1

Scenario
Statistica

Scenario
Analisi di laboratorio

Playlist
Chimica

Eventi e conferenze

Scenario
Yearbook 2023

Scenario
Musical Cats

Scenario
Musica concentrazione

Scenario
Quadri Rinascimento

Playlist
Yearbook

Info Point

Scenario
Prima aula

Scenario
Eventi in programma

Scenario
Mappa Università

Multimedia
Accesso Wi-Fi

Multimedia
Accesso

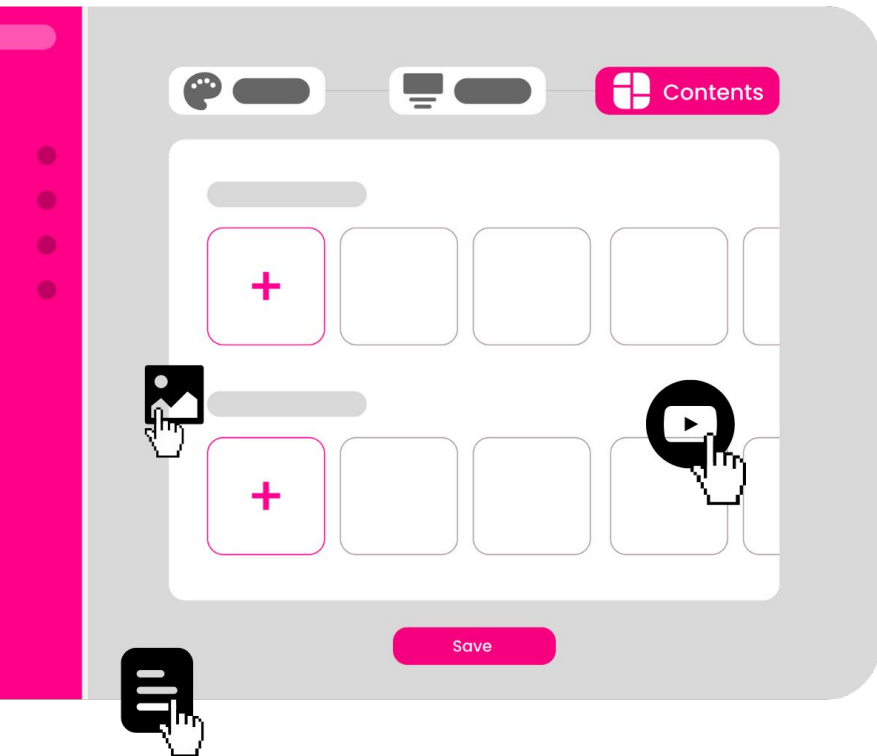

Manage all your content the way you want!

Organize and manage your content in groups and quickly access everything you need, without having to go through Livesignage every time.

- **Playlist:** Launch playlists
- **Apps:** Interact with Livesignage apps
- **Media content:** Videos, images, and messages you can update in real time
- **Quick shortcuts:** Set up fast actions to start or interrupt content
- **Simultaneous sync:** Launch content on multiple displays with a single tap

...and much more. These are just some of the content types you can group together in one place!

Full device control without the hassle



Not just content! With Live Controller, you can also manage your device hardware effortlessly.

- **Turn off all displays:** Create a dedicated folder to turn off or restart all displays with a single tap.
- **Control multiple devices:** Power on or off individual screens or entire groups of devices directly from the menu.
- **Quick setup:** Set custom commands for instant hardware control.

Touch or remote?

You decide

Easily navigate through your content using either touch or a remote control.

- **Interactive display:** Just one tap to select playlists, apps, or manage hardware.
- **Remote control:** Use the remote to browse through content like you would on a smart TV.
- **Maximum flexibility:** Works with all screen types interactive or non-interactive.



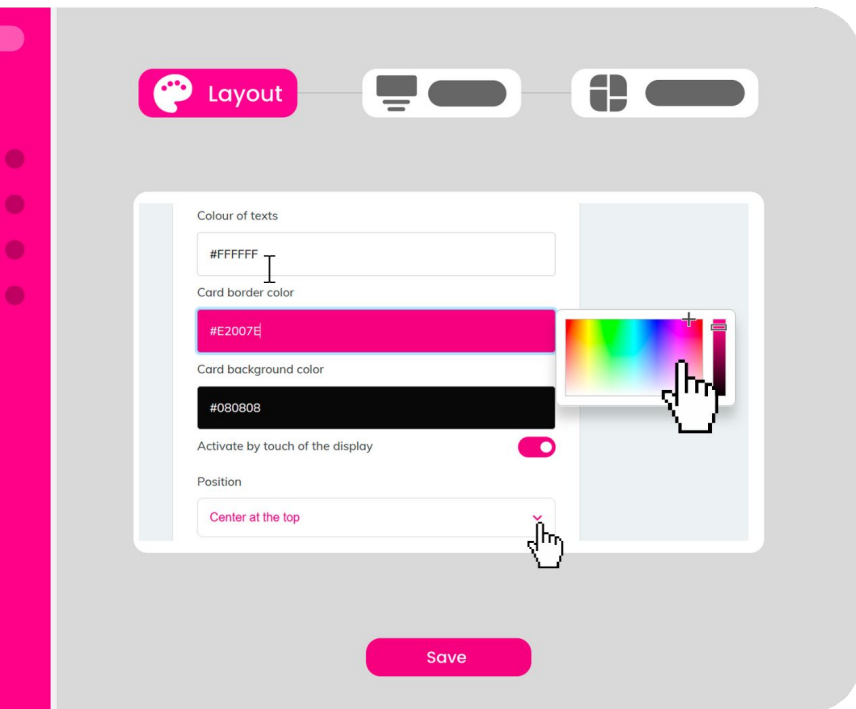

Your style, your control

Customize the design of Live Controller to match your brand and your style!

- **Custom colors:** Choose colors and backgrounds that reflect your visual identity.
- **Tailored layout:** Arrange cards and folders based on your specific needs.
- **Icons and interface:** Customize icons and UI for a unique, professional look.

Retail, events, schools, corporate... it works everywhere!

Live Controller is the ideal solution for any environment or industry. Whether you're managing a showroom, a conference room, or an exhibition space, the app adapts perfectly to your needs.

With a **single interface**, you can **control both content and devices in real time**, making management easier and enhancing the audience's experience. From in-store promotions to corporate presentations, Live Controller gives you the flexibility and control you need, no matter the setting!

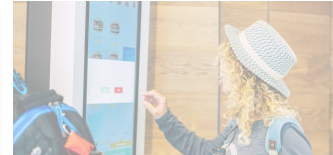
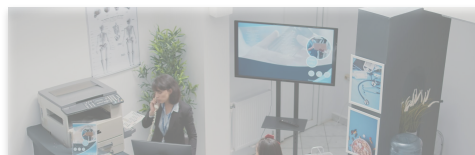



LIVESIGNAGE

WEB www.livesignage.com

MAIL hello@livesignage.it

LDN livesignage