

PLAN POSEBNIH DIJELOVA PRIZEMLJA

PRIZEMLJE

M=1:100



znak	boja	naziv	P zatvoreno	P otvoreno
------	------	-------	-------------	------------

C		Boravak/Blagovaonica	P=37,70 m2	
		Kuhinja	P=7,80 m2	
		WC	P=1,83 m2	
		Predprostor	P=1,99 m2	
		Ulaz	P=2,96 m2	
		Natkrivena terasa		P=5,96 m2
		Garaža 3	P=19,02 m2	
		Grijanje	P=2,04 m2	
		Vrt/Travnjak-5		P=67,86 m2

ZP2		Stubište 4		P=7,53 m2
-----	--	------------	--	-----------

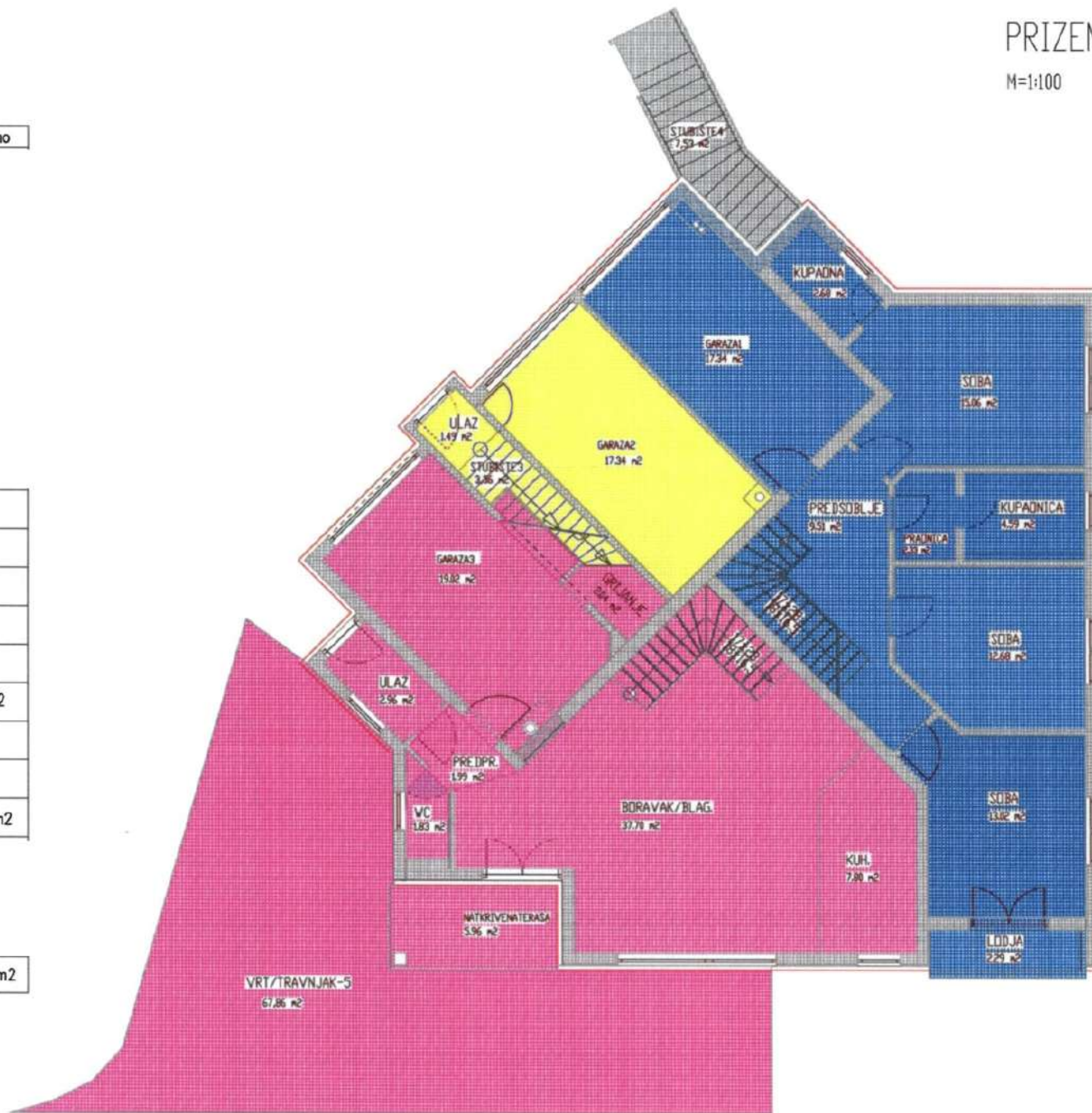



PLAN POSEBNIH DIJELOVA SUTERENA

SUTEREN

M=1:100



C		Spremište	P=24,64 m ²
ZP1		Stubište 2	P=7,89 m ²